

ECONOMICAL LVDTs WITH IN-LINE SIGNAL CONDITIONER

LD610 Series

±1.5 to ±250 mm
(±0.06 to ±10")

Starts at
\$415



- ✓ ±10 Vdc Output
- ✓ IP66 Environmental Rating
- ✓ Guided Core with Removable Spring
- ✓ Stainless Steel Body and Carrier

The LD610 Series comprises economical LVDTs with in-line signal conditioners, available in stroke lengths from ±1.5 to ±250 mm (±0.06 to ±10"). They feature a guided core with standard spring loading. For applications requiring free travel, the spring can easily be removed in the field. The LD610 Series operates on a ±15 Vdc supply and provides a ±DC voltage output.

SPECIFICATIONS

Excitation Voltage:

±15 Vdc @ 18 mA max

Output: ±10 Vdc

Linearity: 0.3% FS

Bandwidth: 250 Hz

Output Current Drive: 8 mA max

Storage Temperature:

Probe: -55 to 70°C (-67 to 158°F)

Signal Conditioner: -55 to 70°C (-67 to 158°F)

Operating Temperature:

Probe: -55 to 70°C (-67 to 158°F)

Signal Conditioner: 0 to 70°C (32 to 158°F)

Zero Temperature Coefficient:

0.025% FS/°C

Span Temperature Coefficient:

0.03% FS/°C

Environmental Rating: IP66

Materials of Construction:

Body: Stainless steel

Core: Nickel/iron alloy



Dimensions: mm (in)

RANGE (mm)	1.5	2.5	5	10	15	25	50	100	250
A	20.3 (0.80)	33.0 (1.14)	42.0 (1.34)	75.0 (2.95)	88.0 (3.46)	102.0 (4.02)	135.0 (5.31)	178.0 (7.01)	216.0 (8.50)
B	28.6 (1.13)	46.3 (1.82)	62.2 (2.45)	112.5 (4.43)	141.2 (5.56)	169.9 (6.69)	256.1 (10.08)	399.7 (15.74)	787.4 (31.0)
C	3.3 (0.13)	4.1 (0.24)	7.5 (0.45)	16.2 (0.64)	24.0 (0.94)	31.4 (1.24)	58.0 (2.28)	108.3 (4.26)	283.0 (11.14)
D (@ null)	32.0 (1.26)	35.5 (1.40)	46.5 (1.83)	59.5 (2.34)	68.5 (2.70)	82.5 (3.25)	128.5 (5.06)	209.5 (8.25)	448.5 (17.66)
E	42.0 (1.65)	50.0 (1.97)	66.0 (2.60)	84.0 (3.31)	100.0 (3.94)	122.0 (4.80)	195.0 (7.68)	326.0 (12.83)	740.0 (29.13)
Spring rate gm/mm	3.03	3.03	2.42	3.51	3.07	2.05	2.99	1.68	N/A

ECONOMICAL LVDTs

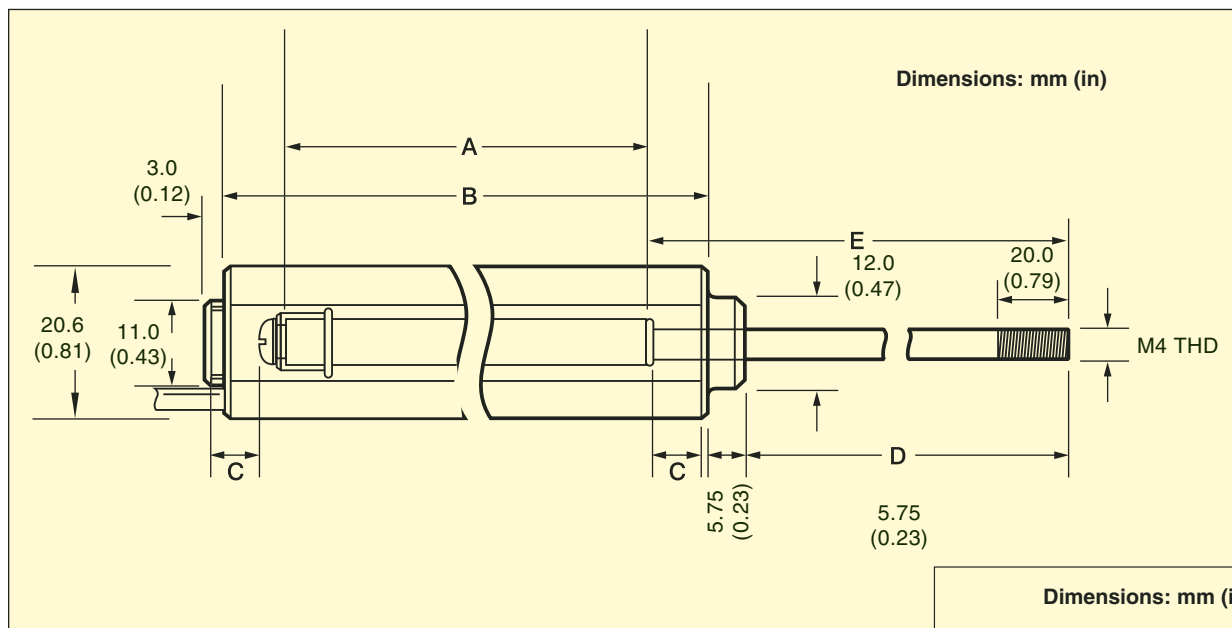

MOST POPULAR MODELS HIGHLIGHTED!

To Order (Specify Model Number)

MODEL NO.	PRICE	RANGE mm (in)	COMPATIBLE METER
LD610-1.5	\$415	±1.5 (±0.06)	DP41-E*
LD610-2.5	430	±2.5 (±0.1)	DP41-E*
LD610-5	475	±5 (±0.2)	DP41-E*
LD610-10	525	±10 (±0.4)	DP41-E*
LD610-15	560	±15 (±0.5)	DP41-E*
LD610-25	595	±25 (±1)	DP41-E*
LD610-50	620	±50 (±2)	DP41-E*
LD610-100	855	±100 (±4)	DP41-E*

* Requires external power supply. For PSS-D15A, \$115, see page C-14. For DP41-E meter, see page D-31.

Comes with complete operator's manual.

Ordering Example: LD610-1.5, economical LVDT with ±1.5 mm (±0.06") range and in-line signal conditioner, \$415.

ACCESSORY

MODEL NO.	PRICE	DESCRIPTION
GE-2530	\$155	Reference Book: Control Valves

ACCESSORIES

MODEL NO.	PRICE	DESCRIPTION
PSS-D15A	\$115	Dual-output external power supply
DP41-E	545	½ DIN high-performance panel meter

SPECIFICATIONS BY RANGE

DESCRIPTION	1.5 (0.06)	2.5 (0.1)	5 (0.2)	10 (0.4)	15 (0.5)	25 (1)	50 (2)	100 (5)	250 (10)
Linear stroke ±mm (±in)	1.5 (0.06)	2.5 (0.1)	5 (0.2)	10 (0.4)	15 (0.5)	25 (1)	50 (2)	100 (5)	250 (10)
Transducer weight g (oz)	38 (1.3)	50 (1.8)	60 (2.1)	86 (3.0)	105 (3.7)	126 (4.4)	195 (6.8)	350 (12.3)	700 (24.5)
Core weight g (oz)	3.8 (0.13)	6 (0.2)	7.5 (0.26)	15 (0.5)	17 (0.6)	20 (0.7)	26 (0.9)	35 (1.2)	42 (1.5)

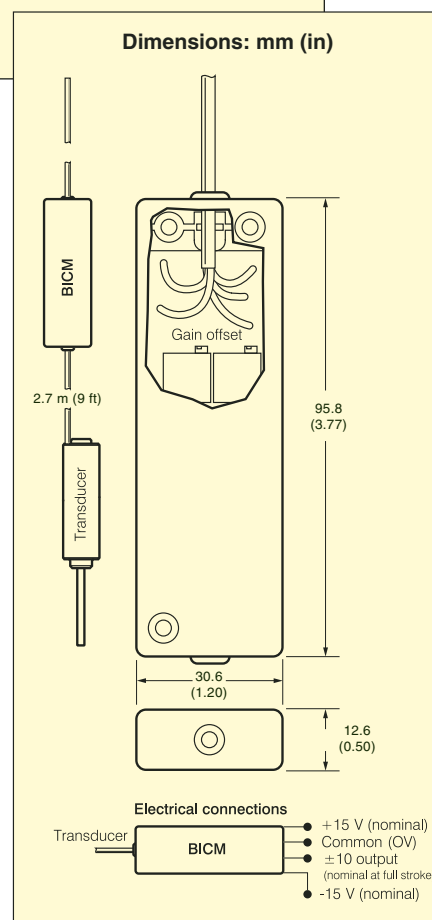

DISPLACEMENT

omega.co.uk[®]

Your One-Stop Source for Process Measurement and Control!

Freephone 0800 488 488 | International +44(0) 161 777 6622 | Fax +44(0) 161 777 6622 | Sales@omega.co.uk

www.omega.co.uk



UNITED STATES

www.omega.com

1-800-TC-OMEGA
Stamford, CT.

CANADA

www.omega.ca

Laval(Quebec)
1-800-TC-OMEGA

GERMANY

www.omega.de

Deckenfronn, Germany
0800-8266342

UNITED KINGDOM

www.omega.co.uk

Manchester, England
0800-488-488
+44-(0)161-777-6611

FRANCE

www.omega.fr

0800-466-342

BENELUX

www.omega.nl

0800-099-33-44



More than 100,000 Products Available!

• Temperature

Calibrators, Connectors, General Test and Measurement Instruments, Handheld Instruments for Temperature Measurement, Ice Point References, Indicating Labels, Crayons, Cements and Lacquers, Infrared Temperature Measurement Instruments, Recorders, Relative Humidity Measurement Instruments, PT100 Probes, PT100 Elements, Temperature & Process Meters, Timers and Counters, Temperature and Process Controllers and Power Switching Devices, Thermistor Elements, Probes and Assemblies, Thermocouples, Thermowells and Head and Well Assemblies, Transmitters, Thermocouple Wire, RTD Probes

• Flow and Level

Air Velocity Indicators, Doppler Flowmeters, Level Measurement, Magnetic Flowmeters, Mass Flowmeters, Pitot Tubes, Pumps, Rotameters, Turbine and Paddle Wheel Flowmeters, Ultrasonic Flowmeters, Valves, Variable Area Flowmeters, Vortex Shedding Flowmeters

• pH and Conductivity

Conductivity Instrumentation, Dissolved Oxygen Instrumentation, Environmental Instrumentation, pH Electrodes and Instruments, Water and Soil Analysis Instrumentation

• Data Acquisition

Communication Products and Converters, Data Acquisition and Analysis Software, Data Loggers Plug-in Cards, Signal Conditioners, USB, RS232, RS485, Ethernet and Parallel Port Data Acquisition Systems, Wireless Transmitters and Receivers

• Pressure, Strain and Force

Displacement Transducers, Dynamic Measurement Force Sensors, Instrumentation for Pressure and Strain Measurements, Load Cells, Pressure Gauges, Pressure Reference Section, Pressure Switches, Pressure Transducers, Proximity Transducers, Regulators, Pressure Transmitters, Strain Gauges, Torque Transducers, Valves

• Heaters

Band Heaters, Cartridge Heaters, Circulation Heaters, Comfort Heaters, Controllers, Meters and Switching Devices, Flexible Heaters, General Test and Measurement Instruments, Heater Hook-up Wire, Heating Cable Systems, Immersion Heaters, Process Air and Duct, Heaters, Radiant Heaters, Strip Heaters, Tubular Heaters