

# Thermocouple Probes

## For Plastic Extruders

- ✓ Service Temperatures to 480°C
- ✓ Single or Dual Element Probes with Quick-Disconnect Termination
- ✓ Rigid Plug or Flexible Extension Models
- ✓ 316 Stainless Steel Tips
- ✓ Many "A" and "B" Dimension Configurations Available

OMEGA's Heavy Duty, Plastic Processing Thermocouples mount directly in extruder heads or die adapters of injection moulding machines with sensor tip projected directly into the plastic melt.

Immersion lengths, styles and mounting arrangements are available in a wide range of possible configurations. All thermocouples are constructed of Type 316 Stainless Steel.

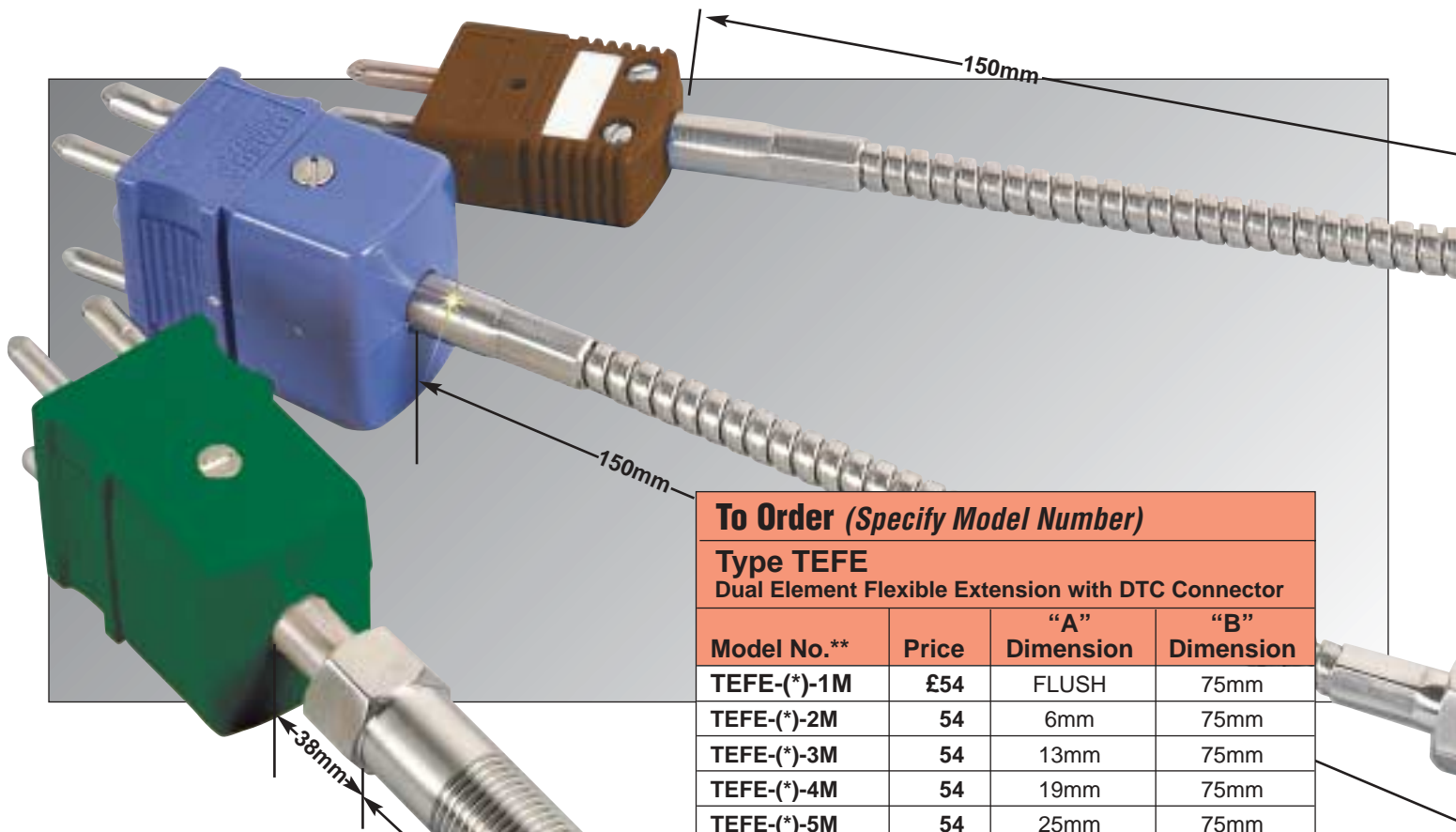

<b>To Order (Specify Model Number)</b>			
<b>Type TERP</b>			
Dual Element Rigid Plug with DTC Connector			
Model No.**	Price	"A" Dimension	"B" Dimension
TERP-(*)-1M	£54	FLUSH	75mm
TERP-(*)-2M	54	6mm	75mm
TERP-(*)-3M	54	13mm	75mm
TERP-(*)-4M	54	19mm	75mm
TERP-(*)-5M	54	25mm	75mm
TERP-(*)-6M	60	FLUSH	150mm
TERP-(*)-7M	60	6mm	150mm
TERP-(*)-8M	60	13mm	150mm
TERP-(*)-9M	60	19mm	150mm
TERP-(*)-10M	60	25mm	150mm

<b>To Order (Specify Model Number)</b>			
<b>Type TEFE</b>			
Dual Element Flexible Extension with DTC Connector			
Model No.**	Price	"A" Dimension	"B" Dimension
TEFE-(*)-1M	£54	FLUSH	75mm
TEFE-(*)-2M	54	6mm	75mm
TEFE-(*)-3M	54	13mm	75mm
TEFE-(*)-4M	54	19mm	75mm
TEFE-(*)-5M	54	25mm	75mm
TEFE-(*)-6M	60	FLUSH	150mm
TEFE-(*)-7M	60	6mm	150mm
TEFE-(*)-8M	60	13mm	150mm
TEFE-(*)-9M	60	19mm	150mm
TEFE-(*)-10M	60	25mm	150mm

\*Insert Calibration Code J, K, T or E  
 \*\*Dual element flexible cables are supplied in 150mm lengths as standard.  
 If greater lengths are desired, consult Sales.

**Model TERP**  
**From**  
**£54**



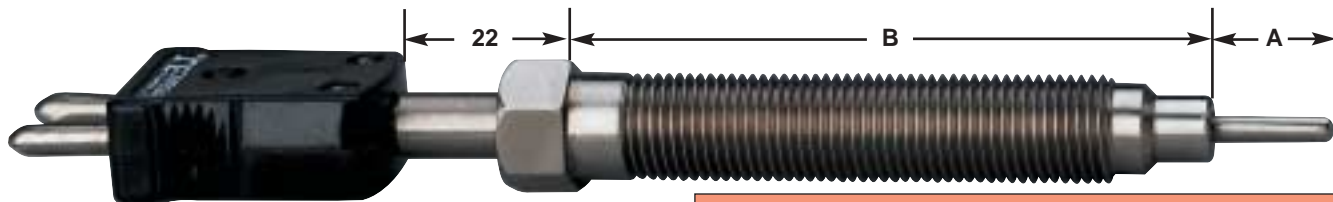

**Model SERP**

From

**£37**

Custom Assemblies Available.  
Consult Sales for Information.

Type SERP Single Element Rigid Plug with OST Connector			
Part no.	Price	"A" Dimension	"B" Dimension
SERP-(*)-1M	£37.00	FLUSH	75mm
SERP-(*)-2M	37.00	6mm	75mm
SERP-(*)-3M	37.00	13mm	75mm
SERP-(*)-4M	37.00	19mm	75mm
SERP-(*)-5M	37.00	25mm	75mm
SERP-(*)-6M	43.50	FLUSH	150mm
SERP-(*)-7M	43.50	6mm	150mm
SERP-(*)-8M	43.50	13mm	150mm
SERP-(*)-9M	43.50	19mm	150mm
SERP-(*)-10M	43.50	25mm	150mm

\*Insert Calibration Code J, K, T or E

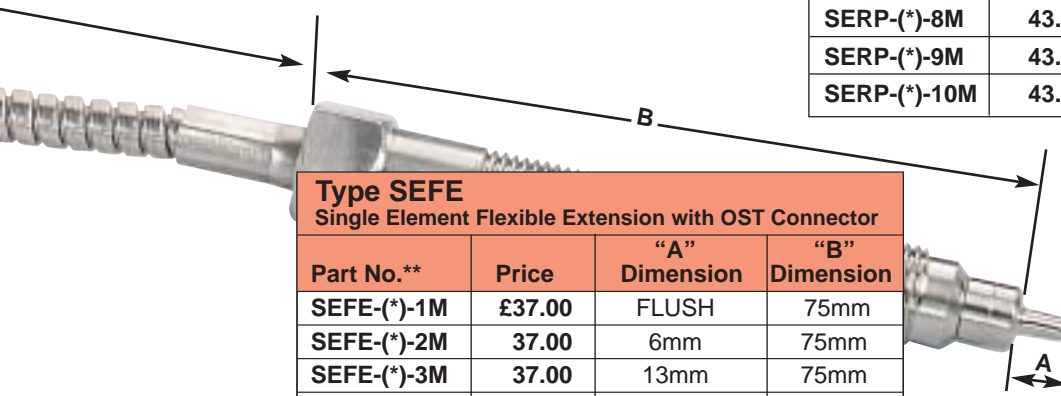

Type SEFE Single Element Flexible Extension with OST Connector			
Part No.**	Price	"A" Dimension	"B" Dimension
SEFE-(*)-1M	£37.00	FLUSH	75mm
SEFE-(*)-2M	37.00	6mm	75mm
SEFE-(*)-3M	37.00	13mm	75mm
SEFE-(*)-4M	37.00	19mm	75mm
SEFE-(*)-5M	37.00	25mm	75mm
SEFE-(*)-6M	43.50	FLUSH	150mm
SEFE-(*)-7M	43.50	6mm	150mm
SEFE-(*)-8M	43.50	13mm	150mm
SEFE-(*)-9M	43.50	19mm	150mm
SEFE-(*)-10M	43.50	25mm	150mm

\*Insert Calibration Code J, K, T or E

\*\*Single element flexible cables are supplied in 150mm lengths as standard. If greater lengths are desired, consult Sales.

**Model SEFE**

From

**£37**

**Detailed Dimensions**

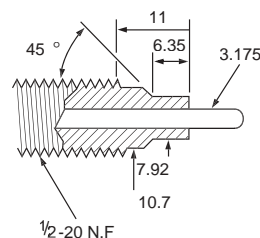

**Recommended drilling dimensions for proper mounting in extruder**

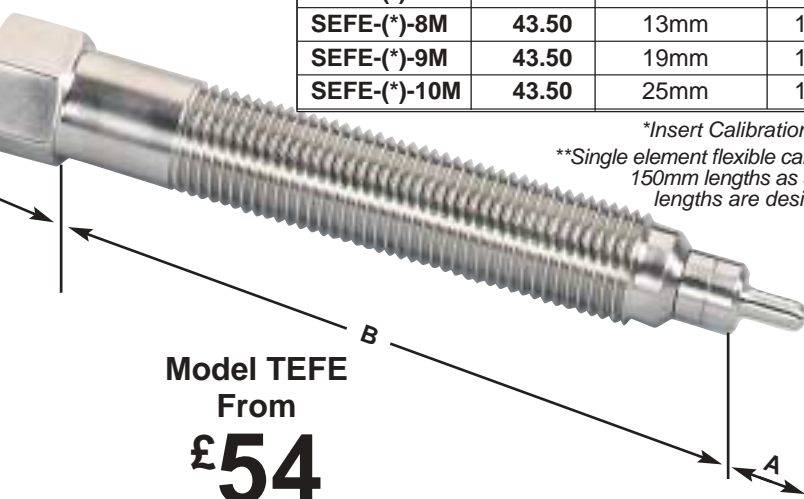
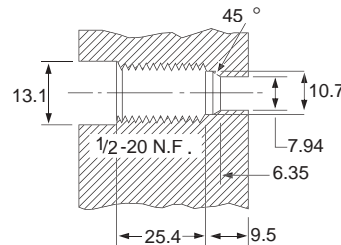

**Model TEFE**

From

**£54**

**Example:**

TERP-K-8M signifies DUAL ELEMENT with RIGID PLUG, plug having an "A" dimension of 13mm, "B" dimension of 150mm, and Type K, CHROME<sup>TM</sup>-ALOMEGA<sup>TM</sup> thermocouple elements.

Single element, UNGROUNDED probes are available for an additional £4.90. Dual element UNGROUNDED probes are available for an additional £7.40. (Please note that standard probes have GROUNDED junctions.)

Discount Schedule	
1-10 Units.....	Net
11-24 Units.....	.5%
25-100 Units.....	10%
101 Units and up.....	Consult sales